

Columbia County Courthouse Plaza

Engraved Brick or Paver Order Form

Downtown Bloomsburg, Inc. invites you to buy an engraved brick or paver to support the construction of the Courthouse Plaza Green Space in Downtown Bloomsburg. The plaza will be a welcoming place to rest, have lunch, meet a friend, or listen to live music.

Your engraved brick or paver could remember a loved one, honor a veteran, mark a graduation, celebrate an anniversary, cherish a favorite pet, display your business name and logo, or record your family's names for posterity. The ideas are endless ...

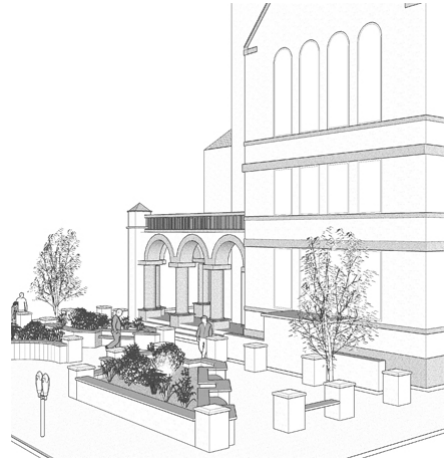

Proposed Courthouse Plaza Green Space

"Quantities Limited"

_____ 4"x8" Standard Brick - \$100
Includes (3) lines of lettering, (15) characters per line
Characters include letters, numbers, spaces & symbols

_____ 8"x8" Concrete Paver - \$200
Includes (4) lines of lettering, (15) characters per line
A logo can be added for an additional \$25

Please fill out a form for EACH brick or paver. Photocopies are acceptable.

Shaded blocks for concrete pavers only!

Ordered by:
 Name: _____
 Street: _____
 City, State, Zip: _____
 Phone: _____
 E-mail: _____

Please make your check payable to:
Downtown Bloomsburg, Inc.
 and mail to:
238 Market Street, Bloomsburg, PA 17815

Please e-mail logos in JPG or Adobe format to:
dbimanager@ColumbiaMontourChamber.com.

If you have questions, please call **570-784-2522**.

Phone number must be included to verify engraving, if needed. DBI cannot be responsible for mistakes on order form.